

Haier iBiza Rhapsody Audible User Guide



Requirements & Tech Specs

- **Only** Win XP with SP 2 or Vista
- Windows Media Player 11.
- **Audible Formats:** 
- **Capacities Available:** 4,8, & 30GB
- **Bookmarking:** No
- **Section Navigation:** Yes
- **Variable Playback Speed:** No
- **FM Radio:** Yes
- **Video:** Yes
- **Removable Battery:** No

How To's:

A. **Playback:** How do I locate/play Audible content on the iBiza Rhapsody?

Step 1. From the iBiza Rhapsody Main Menu, select **Music** and then select **Audiobooks**.

Step 2. Highlight and select the title you want to play.

B. **Rewind/Fast-Forward:** How do I rewind/fast-forward through my Audible content on the device?

1. **Rewinding:** While playing a title hold down the **skip back** button to rewind with in a title.

2. **Fast-Forwarding:** While playing a title hold down the **skip forward** button to fast forward with in a title.

C. **Section Navigation:** How do I use section navigation?

Step 1. While playing a title press the **skip forward** button to skip to the next section.

Step 2. While playing a title press the **skip back** button to go to a previous section.

Buttons and Functions

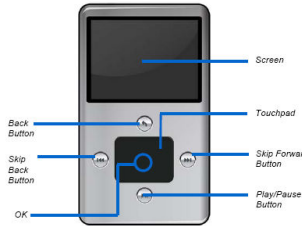

Front View of *ibiza Rhapsody*

Button or Control	What You Can Do	Details...
LCD screen	<ul style="list-style-type: none"> Display content. 	<ul style="list-style-type: none"> To adjust screen settings, go to Main Menu, "Settings," "Display settings."
Play/Pause button	<ul style="list-style-type: none"> Play or pauses the currently selected media. 	<ul style="list-style-type: none"> Press and hold the Play/Pause button while music is playing, to go to the "now playing" screen.
Touchpad	<ul style="list-style-type: none"> Navigate within <i>ibiza Rhapsody</i>. 	<ul style="list-style-type: none"> Please consult the section entitled "A Tour of <i>ibiza Rhapsody</i>," for instructions on how to use the Touchpad.
Press the Touchpad	<ul style="list-style-type: none"> Select onscreen elements. 	

Button or Control	What You Can Do	Details...
Back button	Return to the previous screen.	<ul style="list-style-type: none"> Press and hold to return to the Main Menu. During text entry, deletes characters.
Skip back button	Display previous or earlier portions of the media.	<ul style="list-style-type: none"> Press more than once or continuously, to go back farther or faster.
Skip forward button	Display next or later portions of the media.	<ul style="list-style-type: none"> Press more than once or continuously, to go forward farther or faster.



Top View of *ibiza Rhapsody*

Button or Control	What You Can Do	Details...
Connect button	Launch the "Get connected" screen.	<ul style="list-style-type: none"> View wireless networks within range. Check connection status. Manage your wireless connection.
Lock switch	Disable all controls except for the volume buttons.	<ul style="list-style-type: none"> To lock <i>ibiza Rhapsody</i>, slide the switch to the right. To unlock <i>ibiza Rhapsody</i>, slide the switch to the left.
Indicator light	<ul style="list-style-type: none"> Assess network availability. Monitor network connection status. Observe network data activity. 	<ul style="list-style-type: none"> Green, flashing: downloading content. Bright green: connected, not downloading content. Dim green: familiar network detected, not connected. Dim orange: unfamiliar network detected. Indicator light off: no network detected, or wireless disabled, and not charging.

Bottom View of *ibiza*



Bottom View of *ibiza*

Button or Control	What You Can Do	Details...
USB port	Connect to <i>ibiza Rhapsody</i> via USB cable.	<ul style="list-style-type: none"> Connect to your PC for data transmission, and to charge <i>ibiza Rhapsody</i>. Connect to the wall charger to charge <i>ibiza Rhapsody</i>.
Docking connector	Connect <i>ibiza Rhapsody</i> to the (optional) docking station, or to any other accessory with a docking port.	Contact device manufacturer for information about other possible connection options.
Reset switch	<ul style="list-style-type: none"> Stop <i>ibiza Rhapsody</i>. Clear current selections. Terminate existing wireless connections. 	<ul style="list-style-type: none"> To press, use a pen tip or other stylus. Use only if <i>ibiza</i> is not responding. <p><i>Note:</i> Pressing the Reset switch resets the device clock. This terminates time-sensitive licenses on downloaded music. Licenses will be restored the next time you connect to the internet.</p>

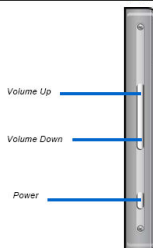

Button or Control	What You Can Do	Details...
Volume up button	Raise the volume.	The volume controls work even when the device is locked and the other controls are disabled.
Volume down button	Lower the volume.	
Power switch	Turn <i>ibiza Rhapsody</i> on and off.	<ul style="list-style-type: none"> To turn <i>ibiza Rhapsody</i> on, press and hold until the LCD screen becomes lit. To turn <i>ibiza Rhapsody</i> off, press and hold the power switch.

